



THE CORPORATION OF THE TOWN OF COBOURG

BY-LAW NUMBER 067-2020

A BY-LAW TO ENTER INTO A LEASE AGREEMENT WITH HORIZON PLASTICS INTERNATIONAL INC. AND THE CORPORATION OF THE TOWN OF COBOURG (NORTHAM INDUSTRIAL PARK, COBOURG).

WHEREAS Section 9 of the *Municipal Act, 2001* S.O. c. 25, as amended (herein referred to as the "Municipal Act") provides that a municipality has the capacity, rights, powers and privileges of a natural person for the purposes of exercising its authority under this or any other Act;

AND WHEREAS pursuant to the General Powers contained in Part II of the Municipal Act, the Council of every Municipality has the authority to sell or lease real property;

NOW THEREFORE the Municipal Council of the Corporation of the Town of Cobourg enacts as follows:

1. THAT the Mayor and Municipal Treasurer are hereby authorized and directed to execute on behalf of the Corporation a Lease Agreement with Horizon Plastics International Inc. in Northam Industrial Park, 740 Division Street, Cobourg, in accordance with the legal description as described in Schedule "A" and more specifically in Schedule "B", "B1", "B2", "B3" and "B4" all of which are attached to this By-law.
2. THAT this By-law shall come into force and effect upon the date of passing.

By-law read and passed in Open Council on this 2nd day of November, 2020.

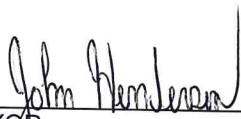
MAYOR

MUNICIPAL CLERK

SITE PLAN

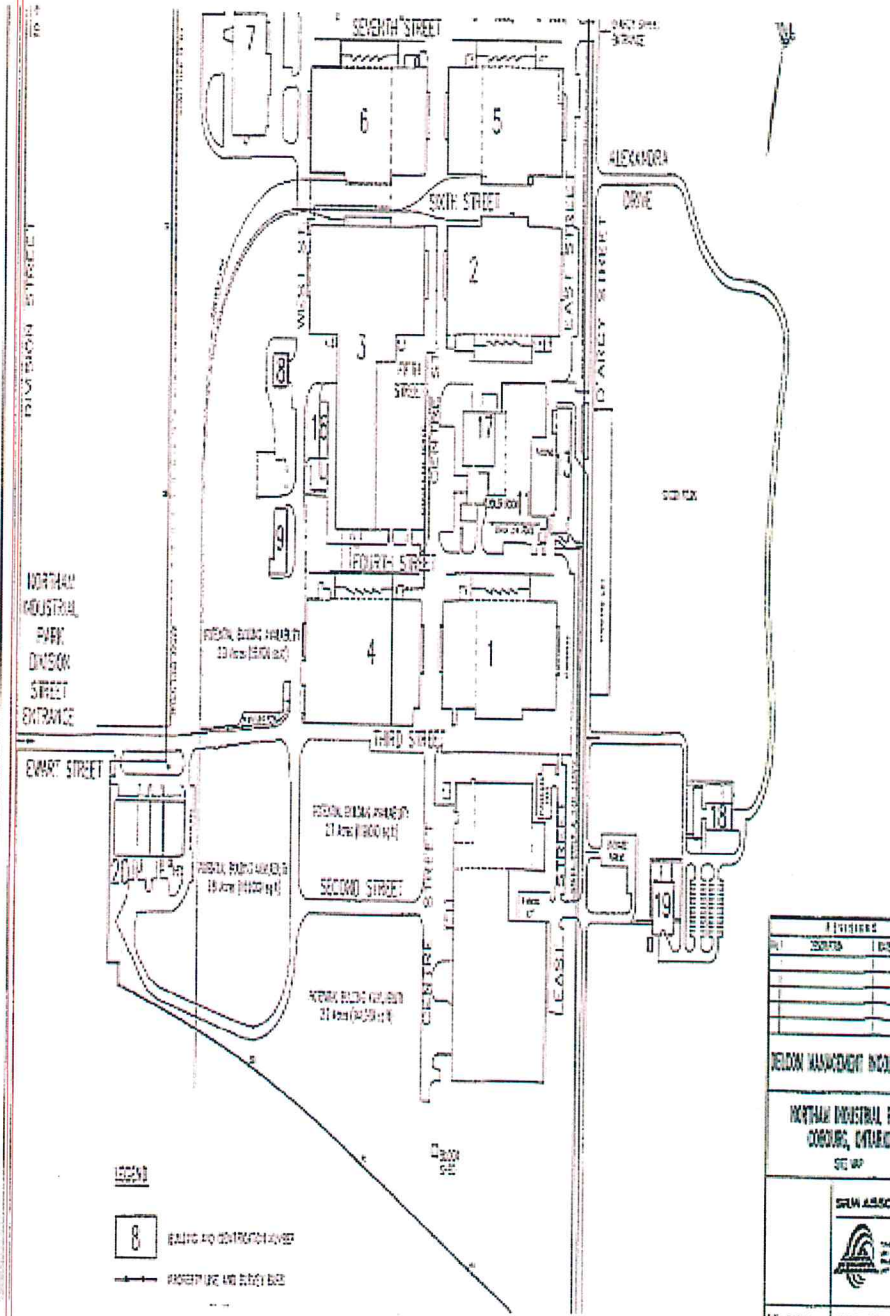

SCHEDULE "B1"

SKETCH OF TENANCY
BUILDING 3 AND ADDITION
 NORTHAM INDUSTRIAL PARK
 COBOURG, ONTARIO
 COUNTY OF NORTHUMBERLAND



METRIC DISTANCES SHOWN ON THIS PLAN ARE IN METRES AND CAN BE CONVERTED TO FEET BY DIVIDING BY 3.048.

- CH 1 DENOTES CEILING HEIGHT ON MAIN LEVEL.
- CH 2 DENOTES CEILING HEIGHT ON MEZZANINE LEVEL.
- T.M. DENOTES TYPICAL.
- DENOTES LIMIT OF MEZZANINE LEVEL.

SURVEYOR'S CERTIFICATE

- 1. CERTIFY THAT:
- 1. THE AREAS SHOWN ARE CORRECT
- 2. THE SURVEY WAS COMPLETED ON DECEMBER 14, 2003

DATE 28 DEC 04 OF [Signature]
 H.S. COLTIE
 ONTARIO SURVEYOR

SURVEY PARTY: CHIEF SURVEYOR
 DRAWN BY: D. THOMPSON
 ENGINEER BY: H.S. COLTIE, O.S.

ONTARIO REALTY CORPORATION
 TORONTO

J.D. BARNES SURVEYING - MAPPING - LAND INFORMATION SERVICES
 40 NORTH GERRARD ROAD
 UNIT 101 SCARBOROUGH, ONT. M1V 1Z4
 TEL: (416) 291-1111 FAX: (416) 291-1111
 WWW: www.jdbarnes.com

NAME	NUMBER	EXPIRES
D.H.T.	K.S.C.	09-25-03-01

28 DEC 2003 9:02AM/2003/03/03

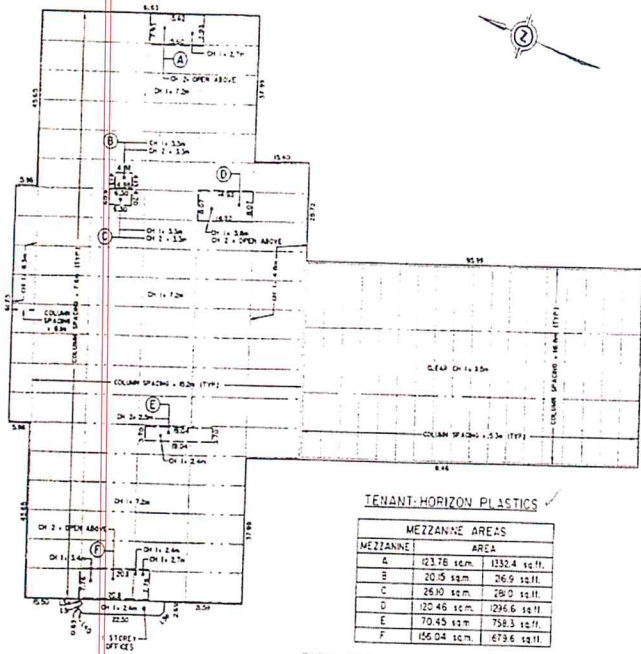

TENANT-HORIZON PLASTICS

MEZZANINE	AREA
A	123.78 sq.m. 1332.4 sq.ft.
B	20.5 sq.m. 220.9 sq.ft.
C	26.10 sq.m. 281.0 sq.ft.
D	122.46 sq.m. 1326.6 sq.ft.
E	70.45 sq.m. 758.3 sq.ft.
F	156.04 sq.m. 1679.6 sq.ft.

TOTAL BUILDING AREA = 1596.90 sq.m. (172027.8 sq.ft.)

SCHEDULE "B2"

5 Horizons Plastics Inc. Lease Agreement (Northam Industrial Park, Cobourg
 067-2020 By-law No.

SCHEDULE "A"

LEGAL DESCRIPTION

BUILDING 3 & 4 & 16

LOCATED ON PART OF PIN 51098-0051 (LT)

LT 5 BLK K PL CADDY (FORMERLY LT 15 CON A HAMILTON) COBOURG; LT 6 BLK K PL CADDY (FORMERLY LT 15 CON A HAMILTON) COBOURG; LT 7 BLK K PL CADDY (FORMERLY LT 15 CON A HAMILTON) COBOURG; LT 8 BLK K PL CADDY (FORMERLY LT 15 CON A HAMILTON) COBOURG; LT 9 BLK K PL CADDY (FORMERLY LT 15 CON A HAMILTON) COBOURG; LT 10 BLK K PL CADDY (FORMERLY LT 15 CON A HAMILTON) COBOURG; LT 11 BLK K PL CADDY (FORMERLY LT 15 CON A HAMILTON) COBOURG; LT 12 BLK K PL CADDY (FORMERLY LT 15 CON A HAMILTON) COBOURG; LT 13 BLK K PL CADDY (FORMERLY LT 15 CON A HAMILTON) COBOURG; PT LT 2 BLK K PL CADDY (FORMERLY LT 15 CON A HAMILTON) COBOURG; PT LT 3 BLK K PL CADDY (FORMERLY LT 15 CON A HAMILTON) COBOURG; PT LT 4 BLK K PL CADDY (FORMERLY LT 15 CON A HAMILTON) COBOURG; PT LT 14 BLK K PL CADDY (FORMERLY LT 15 CON A HAMILTON) COBOURG; PT GLEBE LT N OF RAILWAY PL CADDY (FORMERLY LT 15 CON A HAMILTON) COBOURG; PT PARKLT E PL CADDY (FORMERLY LT 16 CON A HAMILTON) COBOURG; PT PARKLOT F PL CADDY (FORMERLY LT 16 CON A HAMILTON) COBOURG; PT PARKLT L PL CADDY (FORMERLY LT 16 CON A HAMILTON) COBOURG; PT WELLINGTON ST PL CADDY COBOURG AS CLOSED BY CG5138 PT 1 39R106 EXCEPT PART 1 39R3729; COBOURG

SCHEDULE "B"

SCHEDULE "B3"

Schedule "B3"
Demised Area

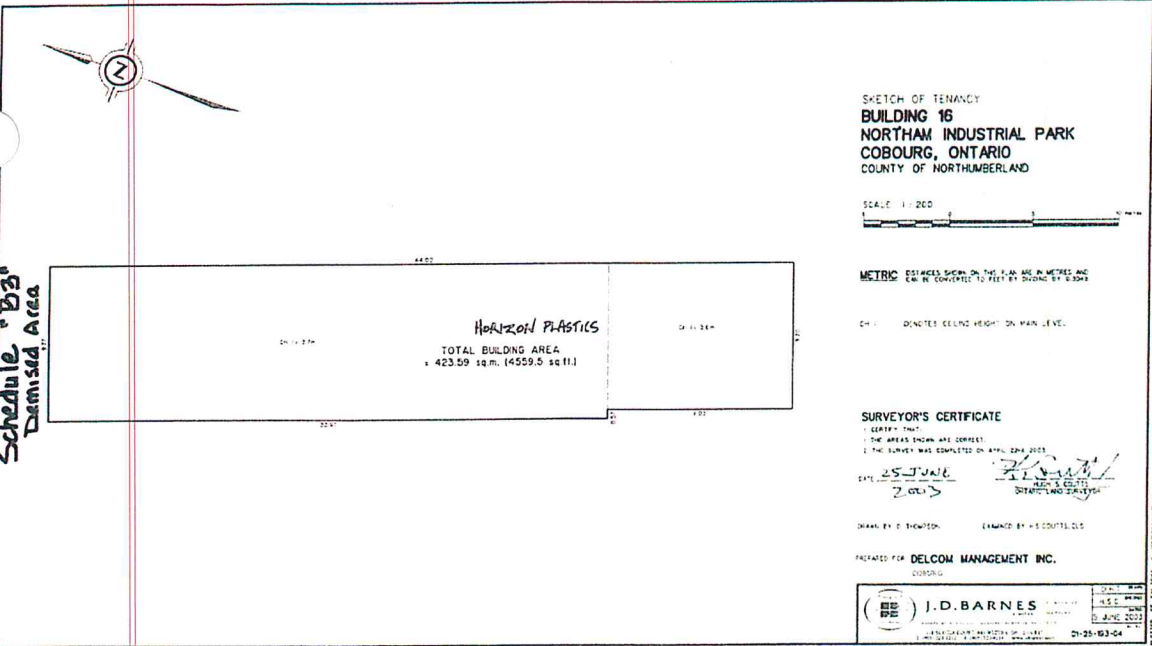

SCHEDULE "B4"

